

# VS8APFF15Q3

## Photoelectric Sensor – Diffuse Mode Sensor with Fixed-Field Background Suppression

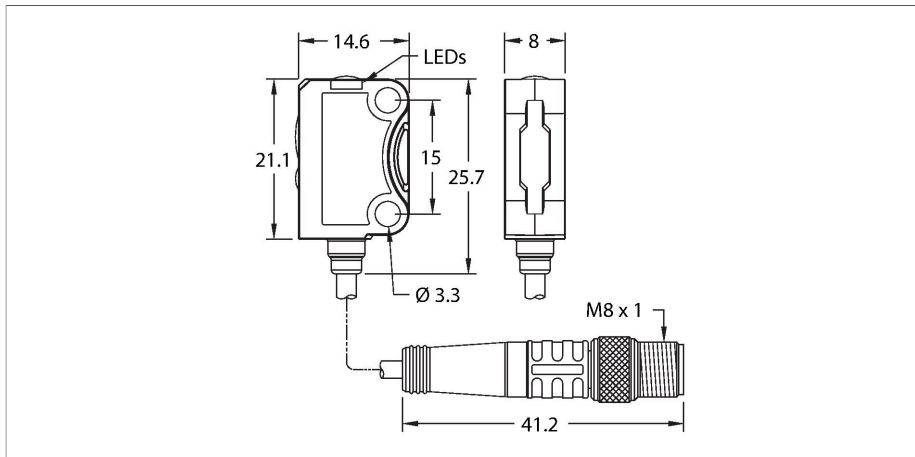

### Technical data

Type	VS8APFF15Q3
ID no.	3803451
<b>Optical data</b>	
Function	Proximity switch
Operating mode	Background suppression, non-adjustable
Light type	Red
Wavelength	650 nm
Range	2...15 mm
<b>Electrical data</b>	
Operating voltage	10...30 VDC
Residual ripple	< 10 % U <sub>ss</sub>
DC rated operational current	≤ 20 mA
Short-circuit protection	yes / Cyclic
Reverse polarity protection	yes
Output function	NO contact, PNP
Switching frequency	1 kHz
Readiness delay	≤ 300 ms
Response time typical	< 0.5 ms
<b>Mechanical data</b>	
Design	Rectangular, VS8
Dimensions	14.6 x 8 x 25.7 mm
Housing material	Plastic, Black
Lens	plastic, PMMA
Electrical connection	Cable with connector, M8 x 1, 0.2 m, PUR
Number of cores	3

### Features

- Connection via 200 m cable, PUR with M8 male connector
- LED emitter, red
- Operating voltage: 10...30 VDC
- PNP switching output, NO contact

### Wiring diagram

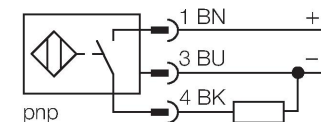

### Functional principle

These miniature photoelectric sensors in a rugged housing are ideal for detecting small parts in harsh environments. The bright and clearly visible light spots help with detecting extremely small objects. Devices with a blue emitter LED are also available, along with laser variants. The 4-pin devices all have a teach input that, in addition to the pushbutton on the devices, can be used to configure the sensor. This allows the switching point to be adjusted or the output behavior to be inverted. ECOLAB certification for devices with a cable connection rounds off the portfolio and allows use in cleanrooms or in the food industry.

Technical data

Ambient temperature	-20...+60 °C
Protection class	IP67
Power-on indication	LED, Green
Switching state	LED, Yellow
Excess gain indication	LED
Tests/approvals	
Approvals	CE cULus

Accessories

SMBQ12A 3074341

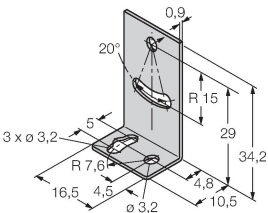

Mounting bracket; material VA 1.4401, for photoelectric sensor, Q12 series

SMBQ12T 3073722

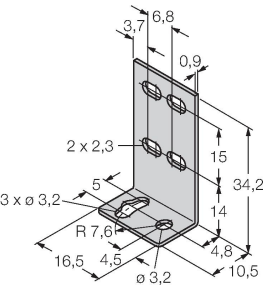

Mounting bracket; material VA 1.4401, for photoelectric sensor, Q12 series

SMBVS8RA 3803492

Mounting bracket, for VS8 series sensors, angled, stainless steel

SMBVS8DT 3803493

Mounting clamp, plastic, black, for VS8 series sensors

Accessories

Dimension drawing Type ID no.

PKG3M-2/TXL

6625550

Connection cable, female M8, straight, 3-pin, cable length: 2 m, sheath material: PUR, black; cULus approval; other cable lengths and qualities available, see [www.turck.com](http://www.turck.com)

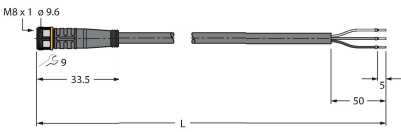

PKW3M-2/TXL

6625556

Connection cable, female M8, angled, 3-pin, cable length: 2 m, sheath material: PUR, black; cULus approval; other cable lengths and qualities available, see [www.turck.com](http://www.turck.com)

