

VS8LEJQ

Photoelectric Sensor – Opposed Mode Sensor, Laser Emitter

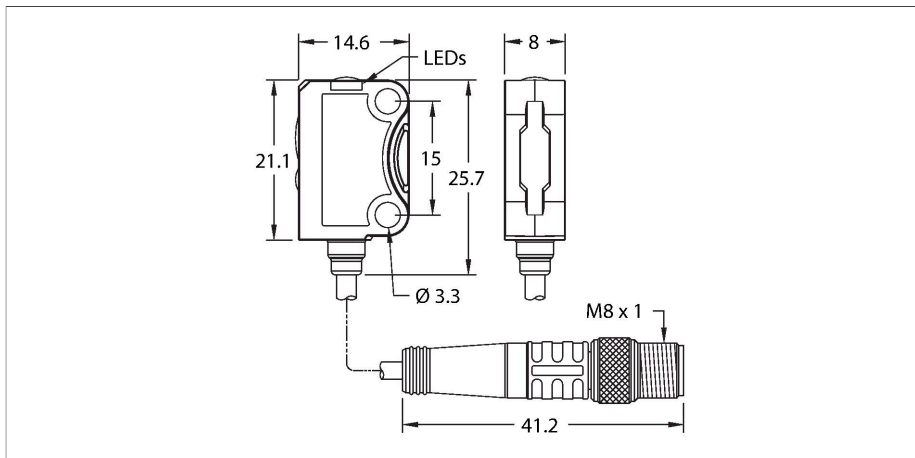

Technical data

Type	VS8LEJQ
ID no.	3803483
Optical data	
Function	Opposed mode sensor
Operating mode	Laser Emitter
Light type	Red
Wavelength	655 nm
Laser class	▲ 1
Range	0...3000 mm
Electrical data	
Operating voltage	10...30 VDC
Residual ripple	< 10 % U _{ss}
DC rated operational current	≤ 20 mA
Short-circuit protection	yes / Cyclic
Reverse polarity protection	yes
Readiness delay	≤ 300 ms
Response time typical	< 0.5 ms
Mechanical data	
Design	Rectangular, VS8
Dimensions	14.6 x 8 x 25.7 mm
Housing material	Plastic, Black
Lens	plastic, PMMA
Electrical connection	Cable with connector, M8 × 1, 0.2 m, PUR
Number of cores	4
Ambient temperature	-20...+50 °C
Protection class	IP67



Features

- Connection via 200 m cable, PUR with M8 male connector
- Laser class 1, red
- Operating voltage: 10...30 VDC
- Laser LED can be switched off via input

Wiring diagram

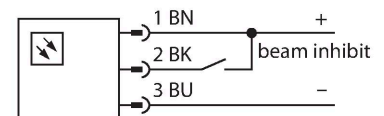

Functional principle

These miniature photoelectric sensors in a rugged housing are ideal for detecting small parts in harsh environments. The bright and clearly visible light spots help with detecting extremely small objects. Devices with a blue emitter LED are also available, along with laser variants. The 4-pin devices all have a teach input that, in addition to the pushbutton on the devices, can be used to configure the sensor. This allows the switching point to be adjusted or the output behavior to be inverted. ECOLAB certification for devices with a cable connection rounds off the portfolio and allows use in cleanrooms or in the food industry.

Technical data

Power-on indication	LED, Green
Excess gain indication	LED
Tests/approvals	
Approvals	CE cULus

Accessories

SMBQ12A3074341



Mounting bracket; material VA 1.4401, for photoelectric sensor, Q12 series

SMBQ12T3073722



Mounting bracket; material VA 1.4401, for photoelectric sensor, Q12 series

SMBVS8RA3803492



Mounting bracket, for VS8 series sensors, angled, stainless steel

SMBVS8DT3803493



Mounting clamp, plastic, black, for VS8 series sensors

Accessories

Dimension drawing	Type	ID no.	
	PKG4M-2/TXL	6625553	Connection cable, female M8, straight, 4-pin, cable length: 2 m, sheath material: PVC, black; cULus approval; other cable lengths and qualities available, see www.turck.com
	PKW4M-2/TXL	6625559	Connection cable, female M8, angled, 4-pin, cable length: 2 m, sheath material: PVC, black; cULus approval; other cable lengths and qualities available, see www.turck.com